

9.14. BCBC & 2.3. BCPC REFERENCE DRAWING

9.14.2.1. Foundation Wall Drainage

1) Unless it can be shown to be unnecessary, the bottom of every exterior *foundation* wall shall be drained by drainage tile or pipe laid around the exterior of the *foundation* in conformance with Subsection 9.14.3. or by a layer of gravel or crushed *rock* in conformance with Subsection 9.14.4.

9.14.5.3. Dry Wells

- 1) Dry wells may be used only when located in areas where the natural *groundwater level* is below the bottom of the dry well.
- 2) Dry wells shall be not less than 5 m from the *building foundation* and located so that drainage is away from the *building*.

2.3.6.1. Tests and Inspection of Drainage or Venting Systems

1) Except in the case of an external *leader*, after a section of a *drainage system* or a *venting system* has been roughed in, and before any *fixture* is installed or piping is covered, a water pressure test or an air pressure test shall be conducted.

9.14.6.4. Catch Basin

1) Where runoff water from a driveway is likely to accumulate or enter a garage, a catch basin shall be installed to provide adequate drainage.

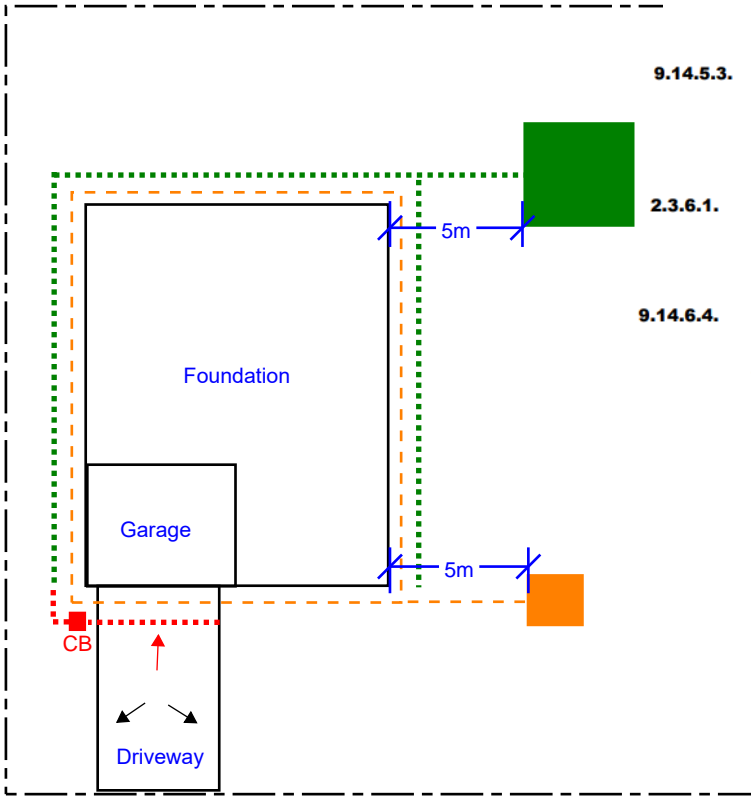

NOTE:

All on-site drainage plans or designs are required to be submitted with any proposed drawings or documents for application of a Building Permit.

Driveways are require to be graded to direct surface drainage on-site.

A registered professional is required to design dry wells.

A separate dry well for the subsurface drainage (foundation drainage) is still required when an off-site storm service provided so a surcharge to the surface drainage will not back flow to the subsurface drainage.

Any part that is shown to be unnecessary by a register professional on record is required to be documented in field reviews.

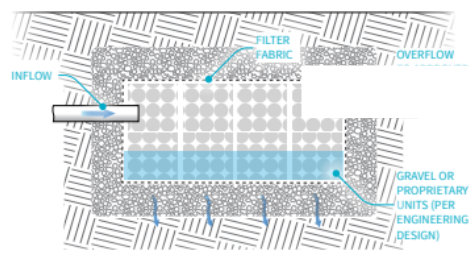
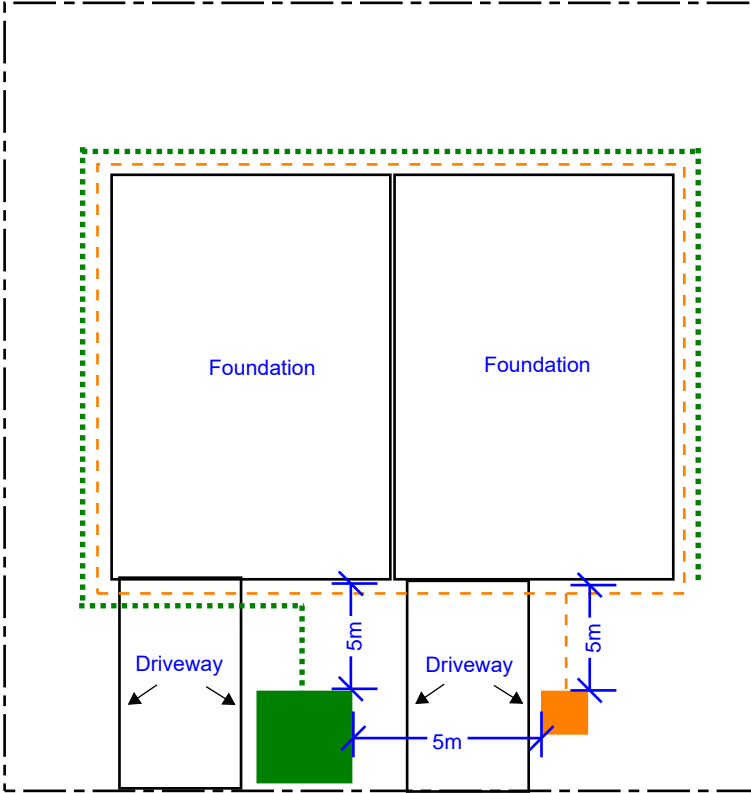

(Figure 8.6 from BC Housing Guide Site and Foundation Drainage)

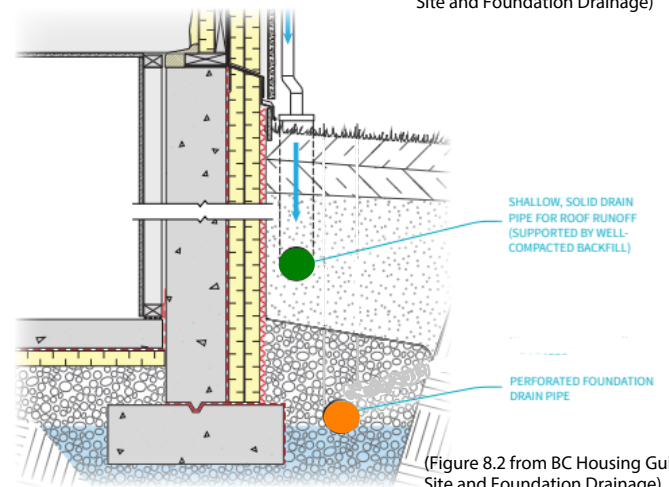

(Figure 8.2 from BC Housing Guide Site and Foundation Drainage)

PLEASE NOTE: These drawings have been created for the specific topic noted and should not be considered as a complete detail meeting all BCBC or BCPC requirements.

PURPOSE: On-site drainage requirements for residential lots.	APP/REV	PAGE
CODE REFERENCE(S): 9.14.2.1., 9.14.5.3., 9.14.6.4. 2018 BCBC & 2.3.6.1. 2018 BCPC	2023-08-11	01