

The following information has been provided to show minimum requirements for permit quality drawings. Drawings are to be to scale and provide enough information for to build the structure and confirm code and city regulation compliance. Graph paper is acceptable. Refer to [COP Deck Bulletin No. 15-05](#)

Site Plans

Site plans must show setbacks, building and structures so that Zoning regulations pertaining to lot coverage and setbacks to property lines can be reviewed.

Zoning Bylaw No.2013-23

Please refer to the appropriate zone designation for required setbacks and lot coverage restrictions.

Section 5.11 Yards and Projections

*Note: covenants, easements and rights-of-ways should also be indicated on the site plan. Refer to [Building Bulletin No.15-03](#)

This information can be obtained through a title search, which can be obtained through the Building Department or [Land Title and Survey](#) office. 1-877-577-5872.

Surveys and existing records

The Building Department may require a survey prepared by certified professional to confirm existing setbacks, covenant boundaries or easements.

Existing records may be obtained from the Building department to assistance in determining sitting or existing permit records.

Please contact the Building Department to arrange for a review of your records.
250 490 2501

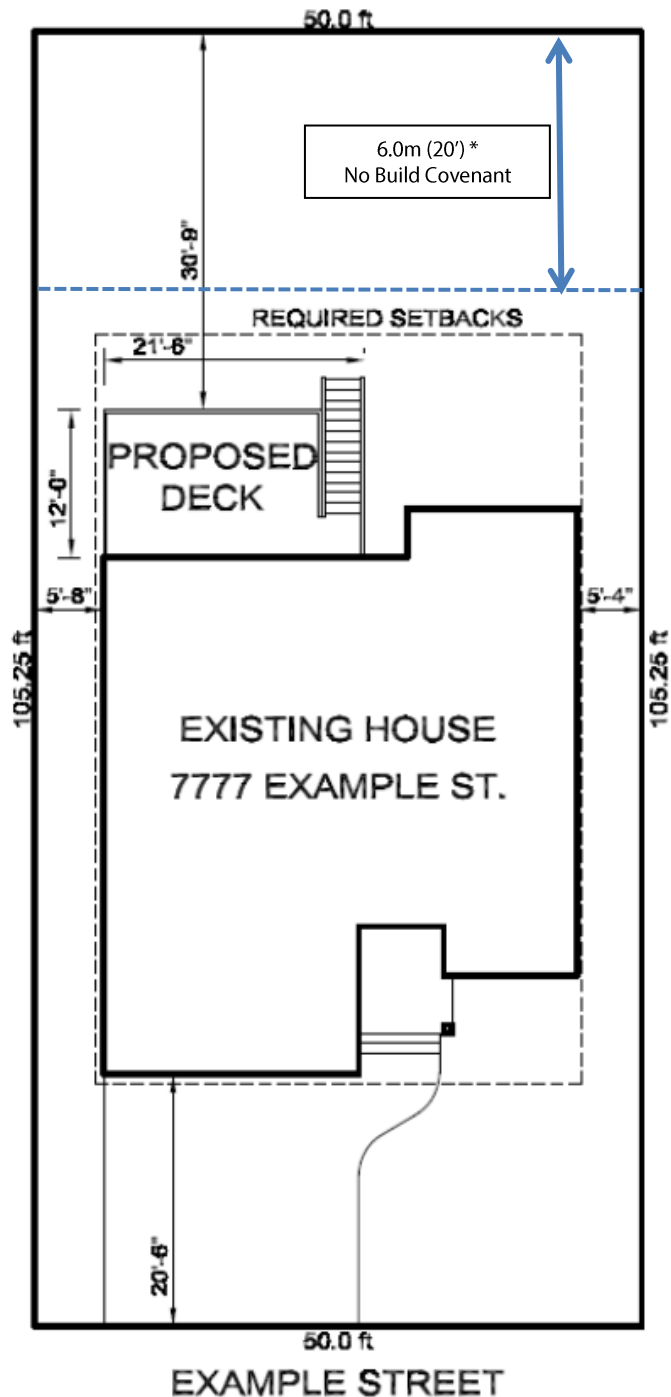

Site Plan example

Scale 1:200m or 1/16" minimum

Foundation Plan

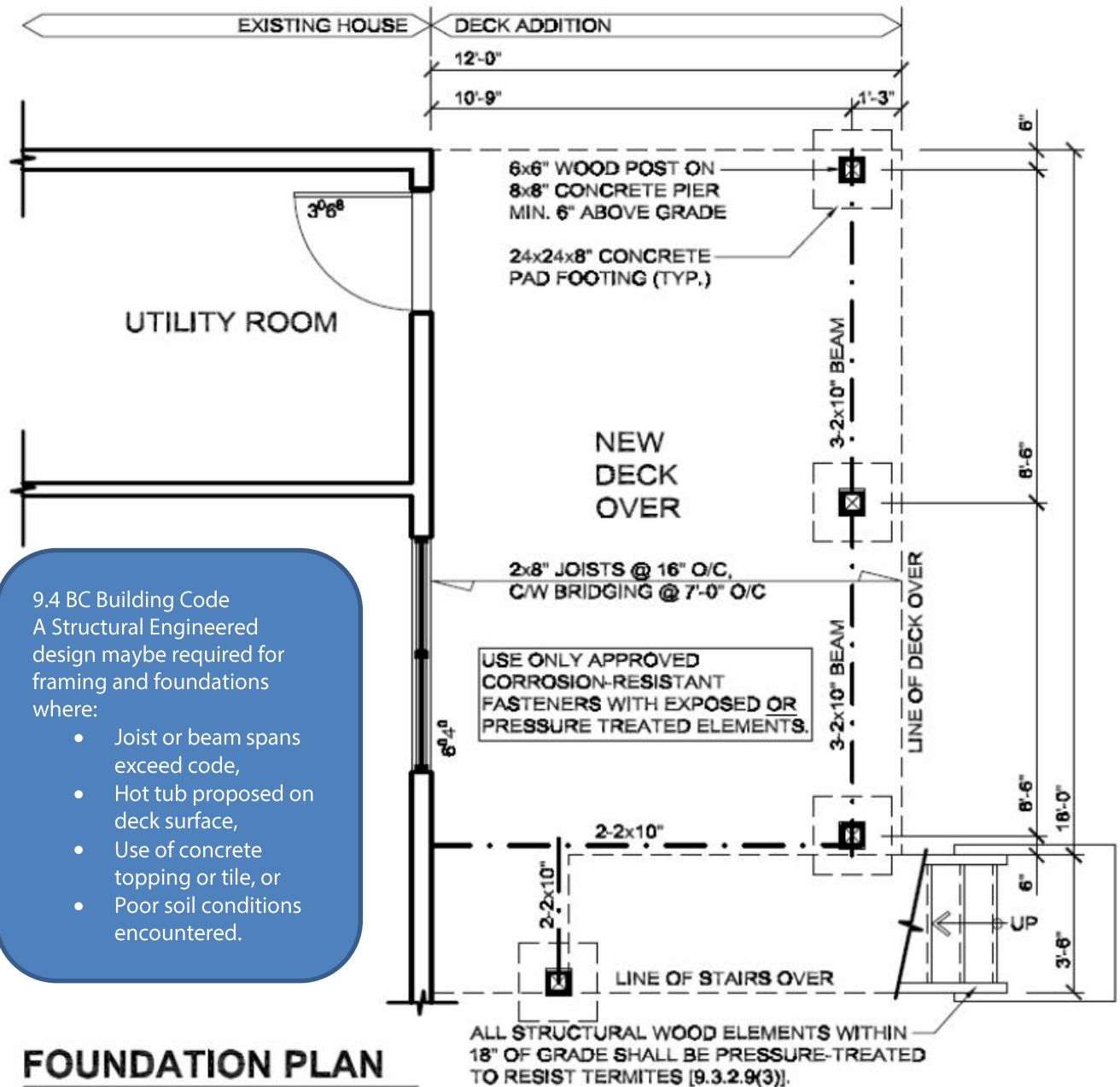

9.4 BC Building Code
A Structural Engineered
design maybe required for
framing and foundations
where:

- Joist or beam spans exceed code,
- Hot tub proposed on deck surface,
- Use of concrete topping or tile, or
- Poor soil conditions encountered.

Deck Plan

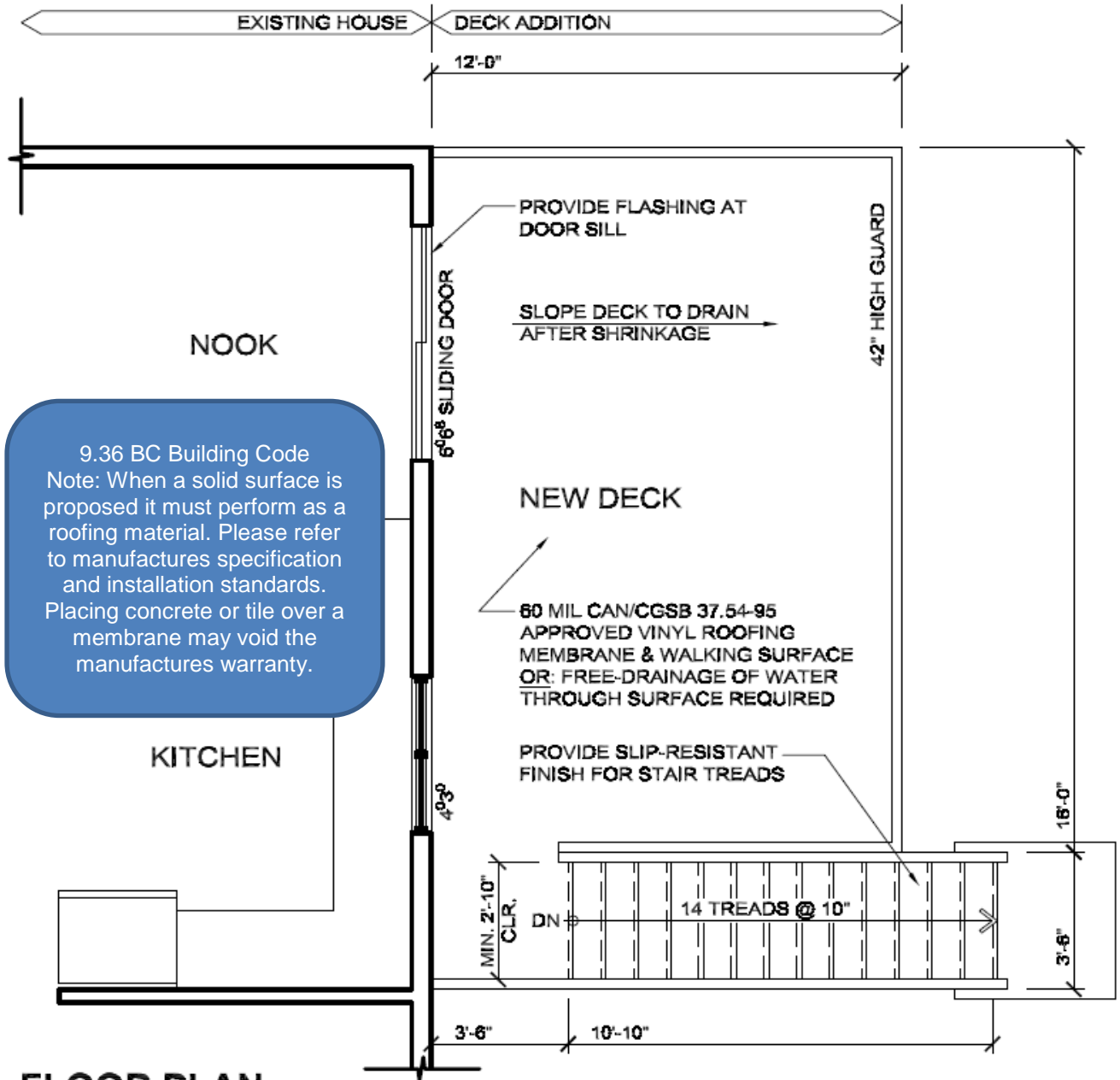

FLOOR PLAN

SCALE: $\frac{1}{4}" = 1'-0"$

**Note: Actual plans must be drawn on minimum 11x17" size paper. Plans must NOT be drawn on graph or lined paper.

Cross Section

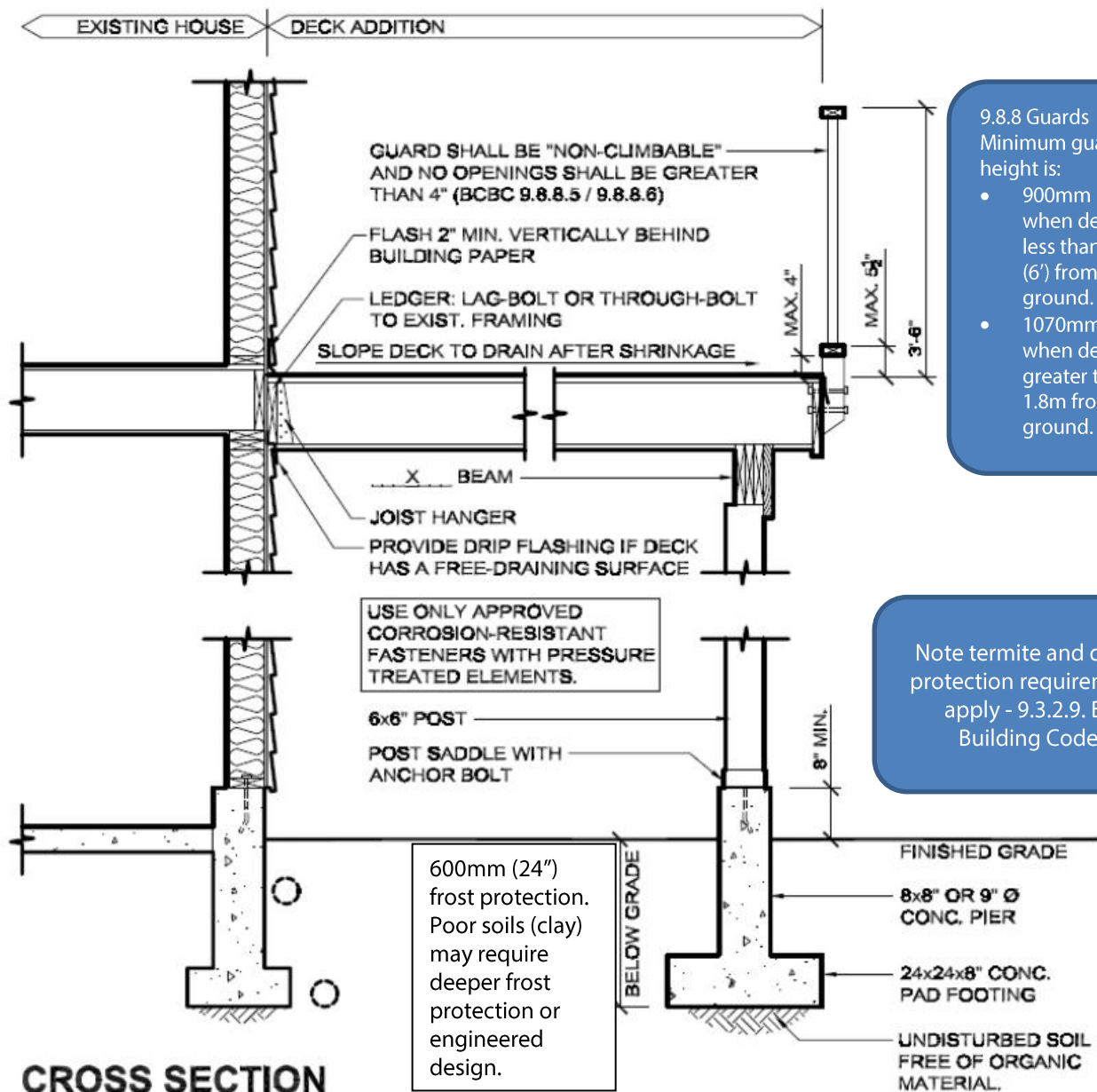

9.8.8 Guards
Minimum guard height is:

- 900mm (36") when deck less than 1.8m (6') from ground.
- 1070mm (42") when deck greater than 1.8m from ground.

Note termite and decay protection requirements apply - 9.3.2.9. BC Building Code.

CROSS SECTION

SCALE: 1/4" = 1'-0"

9.8.8.2 Glass Guards
The use of glass as the main structural component of a guard must be designed by an Engineer. See COP Building Bulletin No.13-03

Vented Deck Assembly

This is an example only. The City of Penticton takes no responsibility for the design or the compliance with the BCBC.

*Minimum effective RSI value for flat roof assembly RSI 4.67 (26.52R)

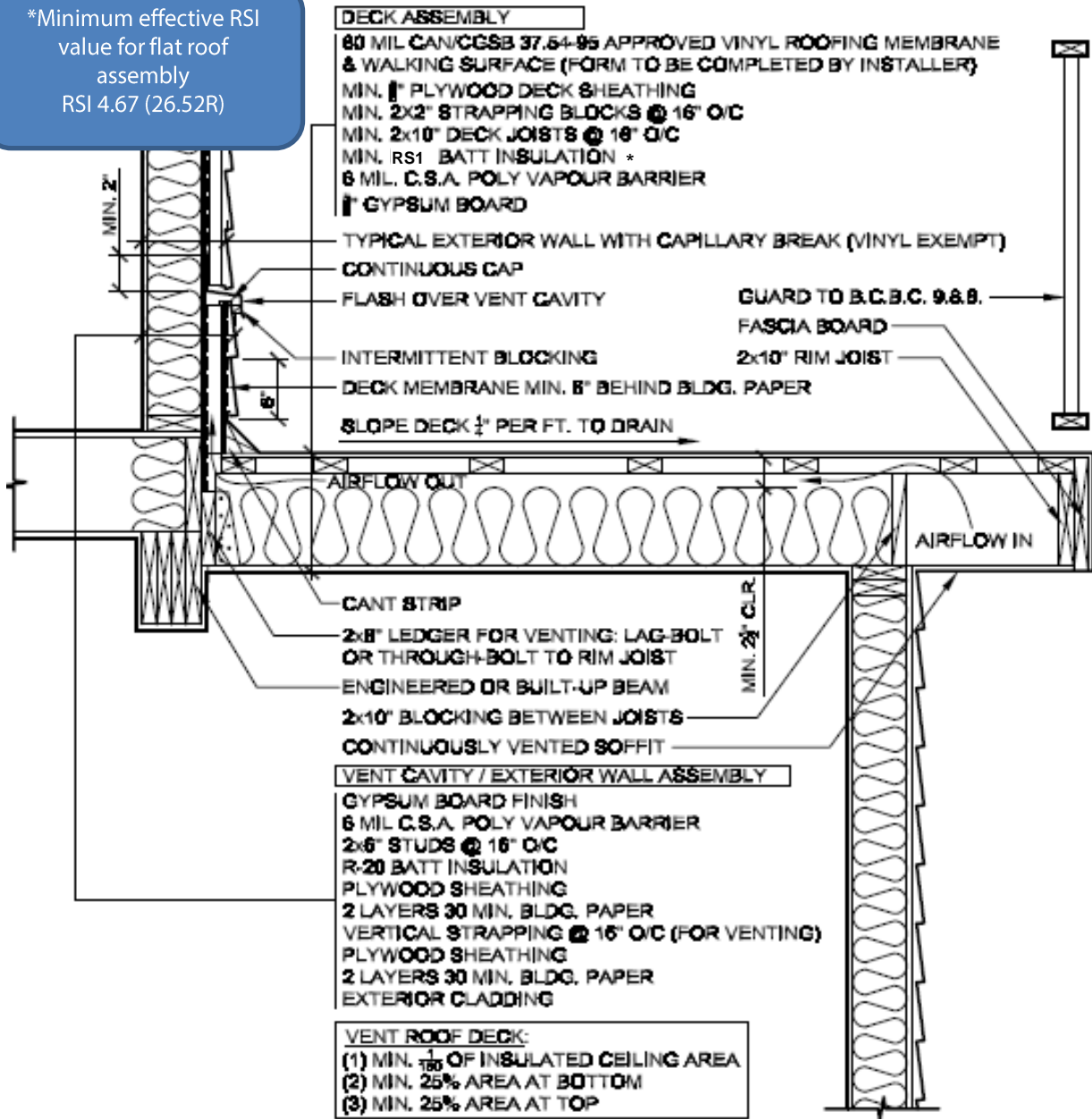

Permit applications and inspection status can be tracked through Development Services On-line. Link to city webpage www.penticton.ca - Community - Resident Services - [Online Services](#)